

P1	07 ACRES LUCKLE NOWAK VOL. 140 PG 833, O.P.R.	P29	NORTHWEST SUBDIVISION VOL. PG 28-27, P.R.	P57	100 ACRES JERRY R. AND DORIS KELIAN VOL. 88 PG 506, O.P.R.	P85	340 ACRES LAUREN HILL ET AL VOL. 76 PG 83, O.P.R.
P2	10 ACRES JOSEPH GOMEZ VOL. 103 PG 263, O.P.R.	P30	481.07 ACRES RUIZ REDEVELOPMENT L.L.C. VOL. 1708 PG 896, O.P.R.	P58	588 ACRES FRANCO LUIS RICHARDO MORALES VOL. 84 PG 676, O.P.R.	P86	52 ACRES COURTNEY P. BLIX VOL. 1374 PG 285, O.P.R.
P3	328.84 ACRES BILLY BRAD VOL. 847 PG 83, O.P.R.	P31	307 ACRES LARRY V. JOHNSON, JR. VOL. 1140 PG 263, O.P.R.	P59	11.35 ACRES STARRS INVESTMENT GROUP VOL. 1854 PG 414, O.P.R.	P87	18 ACRES WILSON COUNTY VOL. 3070 PG 173, O.P.R.
P4	2 ACRES BERNICE WAGEL VOL. 1088 PG 145, O.P.R.	P32	28.88 ACRES 465 DODDLY PARTNERSHIP VOL. 1408 PG 76, O.P.R.	P60	62.2 ACRES STARRS INVESTMENT GROUP VOL. 1854 PG 414, O.P.R.	P88	37.0 ACRES ROBERT M. FLORES VOL. 584 PG 482, O.P.R.
P5	WETLANDS SUBD. VOL. 4 PG 25, P.R.	P33	62 ACRES LARRY D. AND MICHELLE TEBBEN VOL. 1581 PG 362, O.P.R.	P61	62 ACRES E. A. PENNINGTON VOL. 384 PG 152, O.P.R.	P89	15.37 ACRES MICHAEL S. DEBBIE DREW VOL. 1454 PG 882, O.P.R.
P6	WELFARE ESTATES VOL. 1 PG 158, P.R.	P34	26.87 ACRES LARRY D. AND MICHELLE TEBBEN VOL. 1581 PG 362, O.P.R.	P62	1.04 ACRES TRINIDAD BARRIENTEZA, JR. VOL. 1543 PG 861, O.P.R.	P90	15 ACRES CLEVERLY ARBONNETT VOL. 1543 PG 861, O.P.R.
P7	5 ACRES J.D. AND ROSALEE BRUNLOW VOL. 370 PG 473, O.P.R.	P35	7.88 ACRES LARRY D. AND MICHELLE TEBBEN VOL. 1581 PG 362, O.P.R.	P63	20.7 ACRES LARRY D. AND MICHELLE TEBBEN VOL. 1581 PG 362, O.P.R.	P91	5 ACRES E. A. PENNINGTON VOL. 384 PG 152, O.P.R.
P8	132 ACRES DENISE DE SHAZO VOL. 1258 PG 10, O.P.R.	P36	18.15 ACRES LARRY D. AND MICHELLE TEBBEN VOL. 1581 PG 362, O.P.R.	P64	207.7 ACRES SUTTERCUP LANE ZOVANCE INDUSTRIES ESMT VOL. 403 PG 66, O.P.R.	P92	5 ACRES MARK CHONGROVE VOL. 1543 PG 861, O.P.R.
P9	840.00 ACRES HIGDON HEIGHTS SUBD. VOL. 107 PG 247, O.P.R.	P37	11.76 ACRES JEANNE M. AND MARSHALL L. LINDGREN VOL. 1335 PG 234, O.P.R.	P65	1.24 ACRES JUAN GARCIA VOL. 1335 PG 234, O.P.R.	P93	5 ACRES SHAWN C. SMITH VOL. 1543 PG 861, O.P.R.
P10	28.80 ACRES RICHARD E. AND NELL F. ULLMANN VOL. 107 PG 247, O.P.R.	P38	26.72 ACRES LARRY D. AND MICHELLE TEBBEN VOL. 1581 PG 362, O.P.R.	P66	5.3 ACRES ORALIA T. FLORES VOL. 1527 PG 83, O.P.R.	P94	5.3 ACRES FRISCOLLA MORALES VOL. 1454 PG 882, O.P.R.
P11	129 ACRES CITY OF FLORESVILLE VOL. 1239 PG 204, O.P.R.	P39	10 ACRES FLORESVILLE INDEPENDENT SCHOOL DISTRICT VOL. 1004 PG 413, O.P.R.	P67	4.82 ACRES DORIAN J. FLORES VOL. 817 PG 535, O.P.R.	P95	847 ACRES LYNN S. SUE WITTEN VOL. 1004 PG 413, O.P.R.
P12	15.00 ACRES SHARON S. AND FRANK L.A. DALLEY VOL. 1275 PG 204, O.P.R.	P40	1.0 ACRES TERESA MERRILL L.L.C. VOL. 1788 PG 883, O.P.R.	P68	1.0 ACRES SILVIA J. AND DAVID F. GARCIA VOL. 458 PG 262, O.P.R.	P96	14 ACRES CAROLYN HANIK VOL. 2008 PG 508, O.P.R.
P13	191.42 ACRES E. CRENSHAW & CO. INC. VOL. 1423 PG 157, O.P.R.	P41	26.2 ACRES RICHARDSON SUBDIVISION VOL. 11 PG 53, P.R.	P69	10.55 ACRES CERRA AND ORALIA T. FLORES VOL. 389 PG 252, O.P.R.	P97	21 ACRES BEE & LETTIE BARNARD VOL. 1988 PG 685, O.P.R.
P14	186.19 ACRES JIMMY E. AND JANET L. HOLT VOL. 888 PG 156, O.P.R.	P42	26.2 ACRES RICHARDSON SUBD. INC. VOL. 1881 PG 382, O.P.R.	P70	26.2 ACRES LORRENZO RAMIREZ VOL. 882 PG 186, O.P.R.	P98	26.2 ACRES LARRY ABBOTT & DALLY HEAS VOL. 882 PG 186, O.P.R.
P15	186.00 ACRES JIMMY E. AND JANET L. HOLT VOL. 888 PG 156, O.P.R.	P43	11.94 ACRES R. D. PARTNERS LTD. VOL. 355 PG 234, O.P.R.	P71	298.45 ACRES LADREN TALEY MILLS 1.817 P. 781, CR 4 & 287 P. 074 DR	P99	11.54 ACRES JIMMY & BONNIE VAN WINKLE VOL. 1454 PG 882, O.P.R.
P16	26.5 ACRES PLUM 191 LTD. VOL. 1300 PG 353, O.P.R.	P44	62 ACRES VORREL VICK VOL. 841 PG 265, O.P.R.	P72	1.875 ACRES MARTIN A. FLORES RODRIGUEZ VOL. 817 PG 281, O.P.R.	P100	10.33 ACRES MARTIN A. FLORES RODRIGUEZ VOL. 1588 PG 405, O.P.R.
P17	15.30 ACRES JIMMY E. AND JANET L. HOLT VOL. 888 PG 286, O.P.R.	P45	61.13 ACRES WADSWORTH PARTNERS LTD. VOL. 1277 PG 886, O.P.R.	P73	2.406 ACRES FRANCO S. & ROSA HERBERA VOL. 804 PG 781, O.P.R.	P101	127.77 ACRES GEORGE S. MICHELLE HILL VOL. 804 PG 781, O.P.R.
P18	58.2 ACRES SANTON JIMENEZ VOL. 347 PG 436, O.P.R.	P46	207 ACRES "NATURAL LAND" 37 ROAD 5388 VOL. 614 PG 482, O.P.R.	P74	98.0 ACRES FLORESVILLE IND SCHOOL DISTRICT VOL. 107 PG 307, O.P.R.	P102	812 ACRES CHERYL JONES VOL. 1174 PG 787, O.P.R.
P19	7.84 ACRES JIMMY E. AND JANET L. HOLT VOL. 159 PG 288, O.P.R.	P47	10.00 ACRES WADSWORTH PARTNERS LTD. VOL. 11 PG 53, P.R.	P75	30.00 ACRES FLORESVILLE IND SCHOOL DISTRICT VOL. 107 PG 307, O.P.R.	P103	15.9 ACRES DE & DI MUECHOWSKI VOL. 982 PG 716, O.P.R.
P20	63 ACRES DANIEL BOULDER VOL. 1592 PG 234, O.P.R.	P48	26.2 ACRES WALMART SUPERCENTER ADDITION VOL. 11 PG 53, P.R.	P76	51.3 ACRES THE GEORGE M. C. INNALE TRUST VOL. 1864 PG 288 AND 277, O.P.R.		
P21	25.01 ACRES EDWARD AND LARRY MOLLNEY VOL. 475 PG 862, VOL. 1287 PG 586, O.P.R.	P49	0.91 ACRES VOL. 11 PG 53, P.R.	P77	31.54 ACRES RONNIE MICHELL VOL. 1101 PG 81, O.P.R.		
P22	12 ACRES JOE PEW VOL. 536 PG 78, O.P.R.	P50	41 ACRES LYN D. SUE WITTEN VOL. 458 PG 428, O.P.R.	P78	138.28 ACRES CROSSBRIDGE DEVELOPMENT, LTD. VOL. 1219 PG 115, O.P.R.		
P23	36.00 ACRES WICKACRE NORTHCREST, L.P. VOL. 1295 PG 85, O.P.R.	P51	15.489 ACRES MCCOY CORPORATION VOL. 285 PG 91, O.P.R.	P79	8.02 ACRES CROSSBRIDGE DEVELOPMENT, LTD. VOL. 1219 PG 115, O.P.R.		
P24	17.2 ACRES EDWARD MOLLNEY VOL. 383 PG 584, O.P.R.	P52	1.00 ACRES MCCOY FLORESVILLE SUBDIVISION VOL. 11 PG 53, P.R.	P80	1.0 ACRES GAYLAND FLECH VOL. 129 PG 83, O.P.R.		
P25	NORTHCREST SUBDIVISION BLOCK 4 VOL. 6 PG 44, P.R.	P53	1.45 ACRES SAN ANTONIO SELF STORAGE II L.L.C. VOL. 1009 PG 483, O.P.R.	P81	10.074 ACRES JEFF AND WENDY THURS VOL. 1873 PG 814, O.P.R.		
P26	NORTHCREST SUBDIVISION BLOCK 4 VOL. 6 PG 44, P.R.	P54	2.28 ACRES DANIEL HERMADIER VOL. 980 PG 516, VOL. 1059 PG 538, O.P.R.	P82	1.0 ACRES REIL AND STEVE GANTY VOL. 884 PG 836, O.P.R.		
P27	NORTHCREST SUBDIVISION BLOCK 7 VOL. 6 PG 78, P.R.	P55	15.447 ACRES ALICE AND DONALD J. STEVENS VOL. 1887 PG 272, O.P.R.	P83	1.215 ACRES ALICE AND DONALD J. STEVENS VOL. 1887 PG 272, O.P.R.		
P28	NORTHCREST SUBDIVISION BLOCK 7 VOL. 6 PG 78, P.R.	P56	17.0 ACRES DANIEL & TERRY BOUF VOL. 1887 PG 272, O.P.R.	P84	2.3 ACRES DANIEL & TERRY BOUF VOL. 1887 PG 272, O.P.R.		

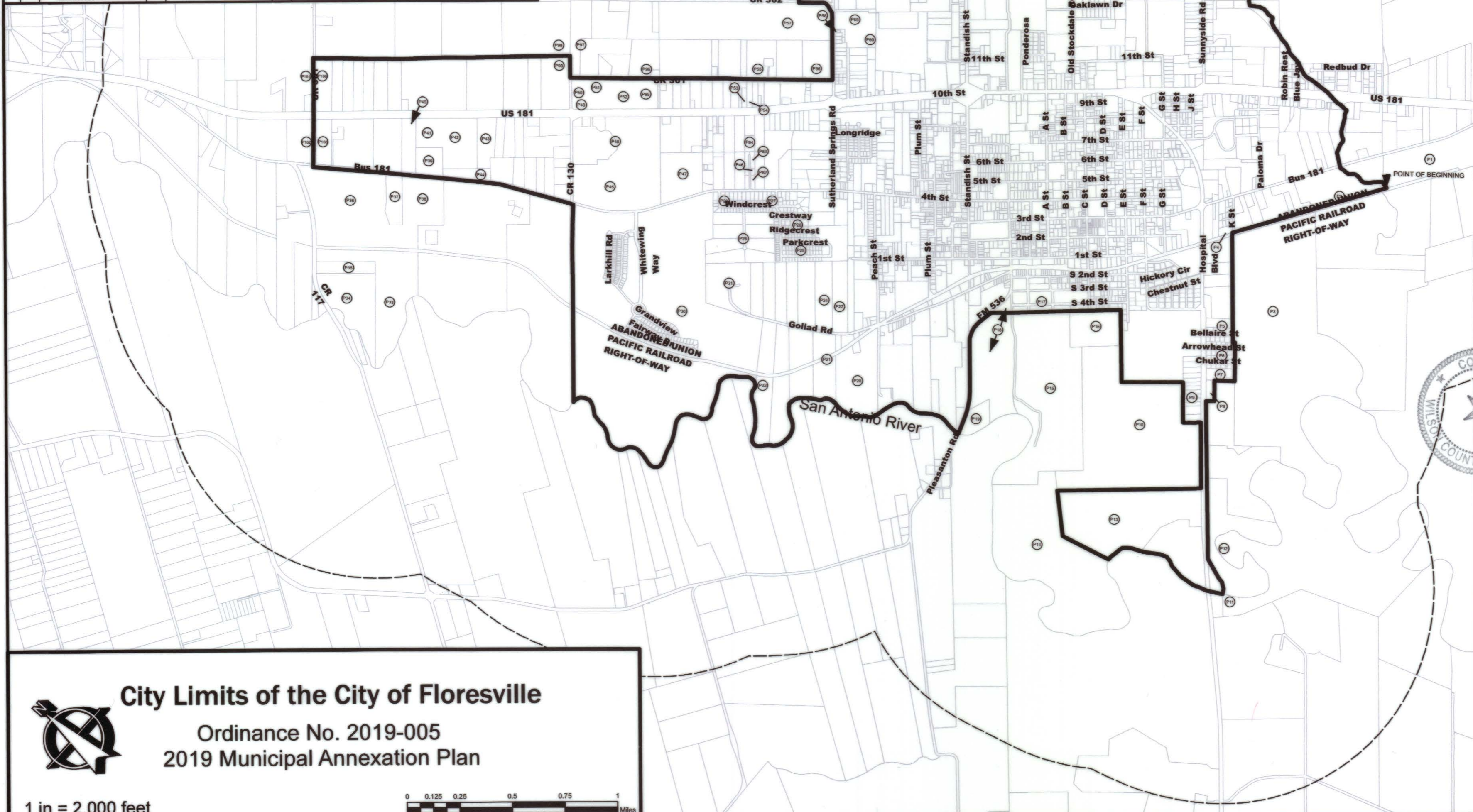

NOTES:  
 1. The City Boundary Map is consistent with City of Floresville Ordinance No. 2019-005, expanding upon the mapping basis established on April 28, 2016 and is not used to convey or establish interest in real property.  
 2. Parcel lines shown for reference only and may differ from platted or deed records as the map depiction herein was not created from on the ground survey.  
 3. In accordance with applicable law, some parcels within this boundary may have non-annexation development agreements in effect which, when recorded in the official public record of Wilson County, describe the conditions for annexation and inclusion within the City Limits of the City of Floresville.

§ State of Texas # 89164  
 § County of Wilson  
 I, Eva S. Martinez, County Clerk of said County, do hereby certify that this Boundary Map was filed for record in my office on the 26 day of Nov, 2019 at 3:46 PM in Book Volume 12 on Page 54 in testimony whereof witness my hand and official seal of this 26 day of Nov, 2019.  
 By Judy Fleming  
 JUDY FLEMING  
 EVA S. MARTINEZ, COUNTY CLERK  
 Wilson County Clerk

This map reflects the Official Corporate Limits of the City of Floresville, Texas, as described in the 2019 Municipal Annexation Plan, effective October 1, 2019, and as approved by the City Council under Ordinance No. 2019-005, August 28, 2019.  
Margaret Tejada  
 Mayor, City of Floresville  
Michelle Campbell-Dippel  
 City Secretary  
 Sworn to and subscribed before me this 26 day of November, 2019. To certify which, witness my hand and seal of office.  
Margaret Tejada  
 Notary Public  
 MARGARET TEJADA  
 My Notary ID # 126612380  
 Expires August 4, 2020

**City Limits of the City of Floresville**  
 Ordinance No. 2019-005  
 2019 Municipal Annexation Plan

